



£1,095 PCM

Linden Close, Radstock BA3 3EJ

Semi-Detached House | 3 Bedrooms | 1 Bathroom

01749 681356



www.keyringlettings.co.uk



Step Inside

Key Features

- Modern three bedroom house
- Recently refurbished
- Gas central heating
- UPVC double glazed windows and doors
- Modern fitted kitchen and bathroom
- Enclosed rear garden with side access
- Garage and allocated parking

Property Description

A newly refurbished three bedroom modern house on the outskirts of Radstock, close to the local schools and amenities. Entrance lobby, living room, modern fitted kitchen with dining space, three bedrooms and modern bathroom with shower over bath. Front and rear gardens, garage with parking space.

Main Particulars

A newly refurbished three bedroom modern house on the outskirts of Radstock, close to the local schools and amenities. Entrance lobby, large living room, modern fitted kitchen with breakfast bar, two double bedrooms and one small single, and modern family bathroom with shower over bath.

Outside, front garden with side access to rear garden, enclosed low maintenance rear garden with patio area.

The property further benefits from gas fired central heating, UPVC double glazed windows and doors, single garage in a nearby block, and off road parking space to front of garage.

Offered unfurnished and available in early March.

Please call us to arrange a viewing, or for further information.



GROUND FLOOR

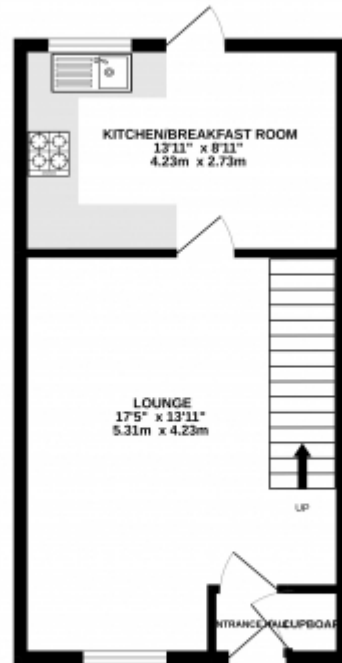

1ST FLOOR

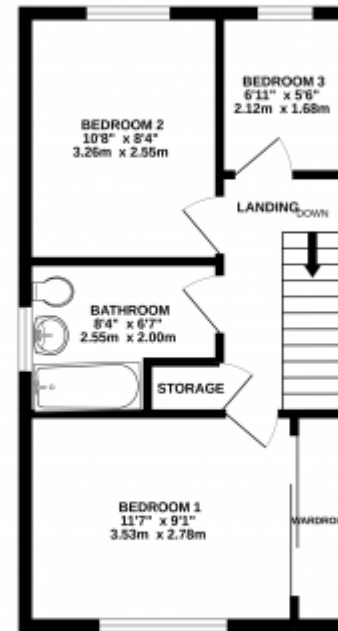

While every attempt has been made to ensure the accuracy of the description contained here, measurements of doors, windows, rooms and any other items are approximate and no responsibility is taken for any error, omission or misstatement. This plan is for illustrative purposes only and should be used in conjunction with any prospective purchase. The services, systems and appliances shown here are not tested and no guarantee as to their operability or efficiency can be given.
Made with Mfloorplan 03/2022

Telephone: 01749 681356



www.keyringlettings.co.uk